

NO.	Item	Specification	Condition
1	Excitation	4-2	
2	Rated Voltage	5V	
3	NO. of Phase	4	
4	Step Angle	7.5°	
5	No. of Step Per Revolution	48	
6	Resistance Per Phase	10±10%Ω	At 20° C
7	Inductance Per Phase	2.1±20%mH	
8	Current Per Phase	0.5A	
9	Holding Torque	120g.cm	
10	Pull-in Rate	750pps MIN	
11	Pull-in Torque	40g.cm	At 100pps
12	Insulation Resisitance	100MΩ MIN	At DC 500V
13	Dielectric Strength	RMS for 2 Sec	At AC 650±50V
14	Insulation Class	Class E	
15	Operating Temp Range	-10 ~ 40° C	
16	Storang Temp Range	-30 ~ 80° C	
17	Detent Torque	45g.cm	
18	Rotor Inertia	<1.0g.cm ²	
19	Stepping Accuracy	7.5° ±7%	
20	Life	3000h MIN	At 20° C 100pps
21	Lead Wrie	UL1061 28AWG	
22	Weight	30g	

Rev.	Revision	Date
01	Update	3/16/2011

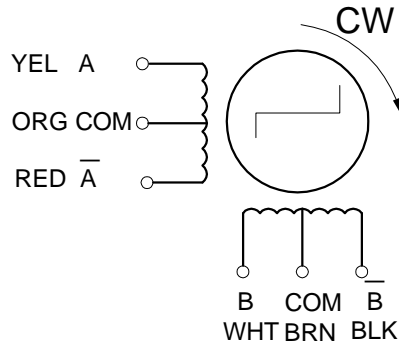
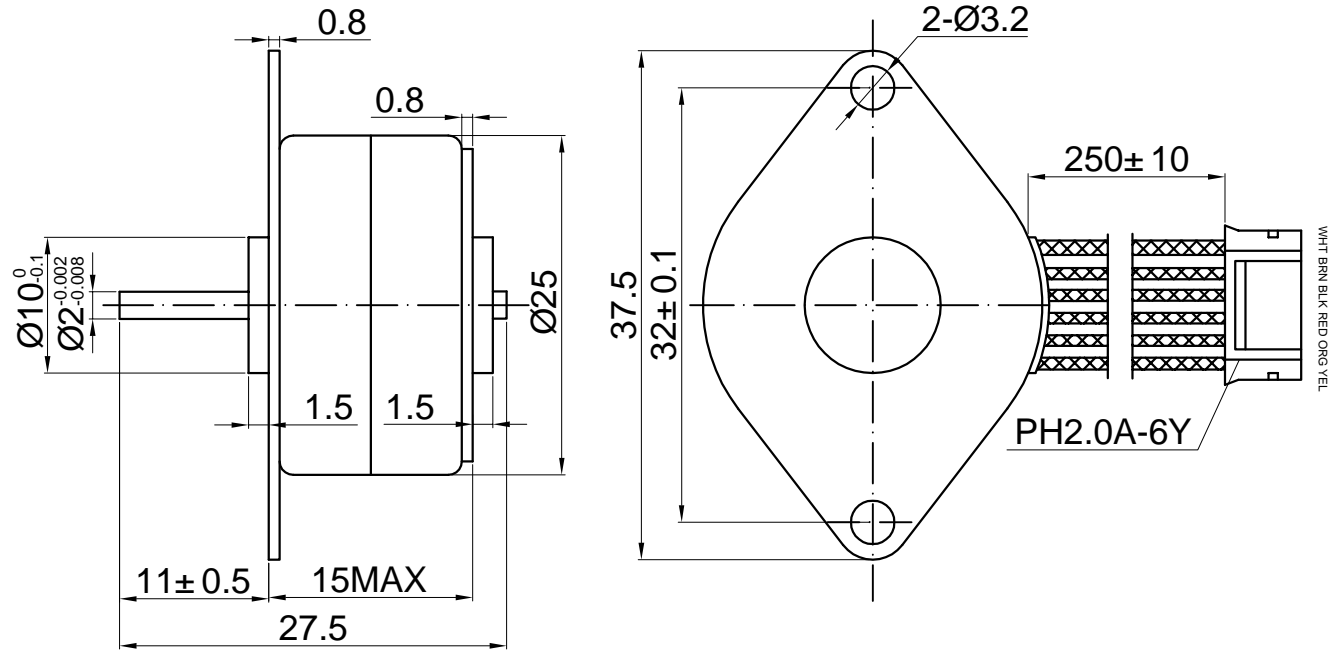

Pin No.	WIRE COLOR	STEP			
		1	2	3	4
1	WHT	-	-	-	-
2	BRN	+	+	+	+
3	BLK	-	-	-	-
4	RED	-	-	-	-
5	ORG	+	+	+	+
6	YEL	-	-	-	-

DRAWN	Eric	4/12/2011	UNIT: mm	
CHECKED	Sara	4/12/2011		
ENG APPR.				
MFG APPR.			Sinotech	
Q.A.				
25BY4801			SIZE A4	P/N 237825
			SCALE: 4:1	Weight(kg):
			REV 01	
			SHEET 1 OF 1	